

## 6. Passenger's Airbag Module

### A: REMOVAL

#### CAUTION:

Refer to “CAUTION” of “General Description” before handling the airbag module. <Ref. to AB-9, CAUTION, General Description.>

- 1) Turn the ignition switch to OFF.
- 2) Disconnect the ground cable from battery and wait for at least 60 seconds before starting work. <Ref. to NT-5, BATTERY, NOTE, Note.>

#### NOTE:

- For models other than STI model, disconnect the ground terminal from battery sensor.
  - On CVT models, shift the select lever into “D” before disconnecting the battery ground cable.
  - For the power seat, remove the console box before removing the battery ground terminal.
- 3) Remove the console box assembly, the cover - shift lever and the panel center LWR on the RH and LH sides. <Ref. to EI-67, REMOVAL, Console Box.>
  - 4) Remove the cover assembly - instrument panel LWR driver. <Ref. to EI-61, REMOVAL, Instrument Panel Lower Cover.>
  - 5) Remove the cover switch - starter.
    - (1) Release the claws and remove the cover switch - starter.
    - (2) Disconnect the connector and aspirator hose.

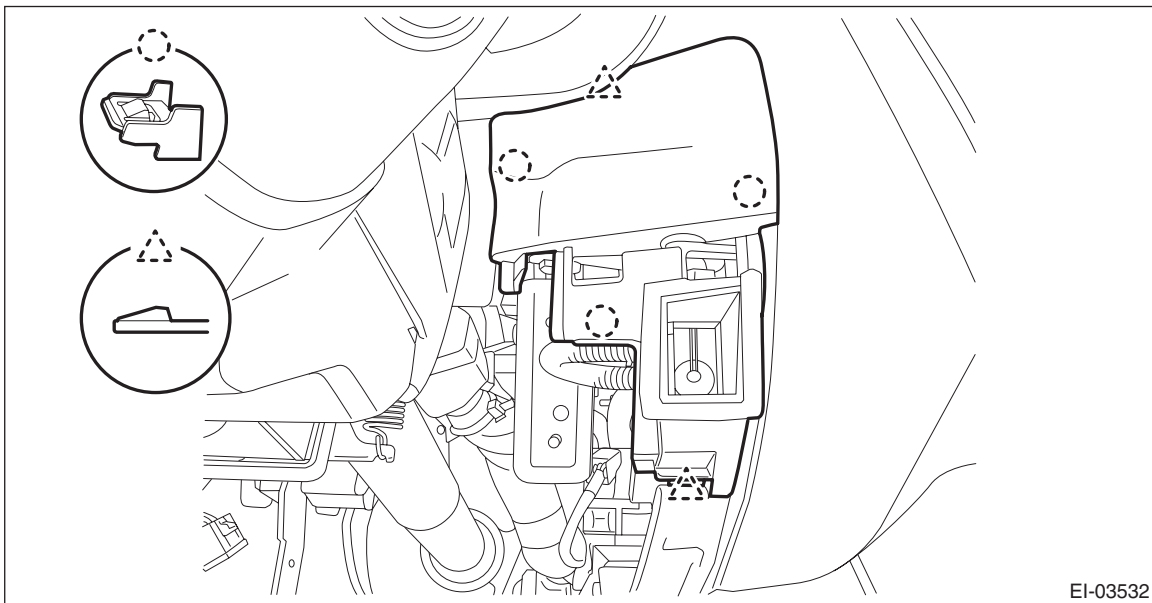

- 6) Remove the panel - switch. (Only model with keyless access)
  - (1) Release the claw of the switch - push button start, and disconnect the connector.
  - (2) Release the claws, and then remove the panel - switch.

- (3) Disconnect the connector and aspirator hose.

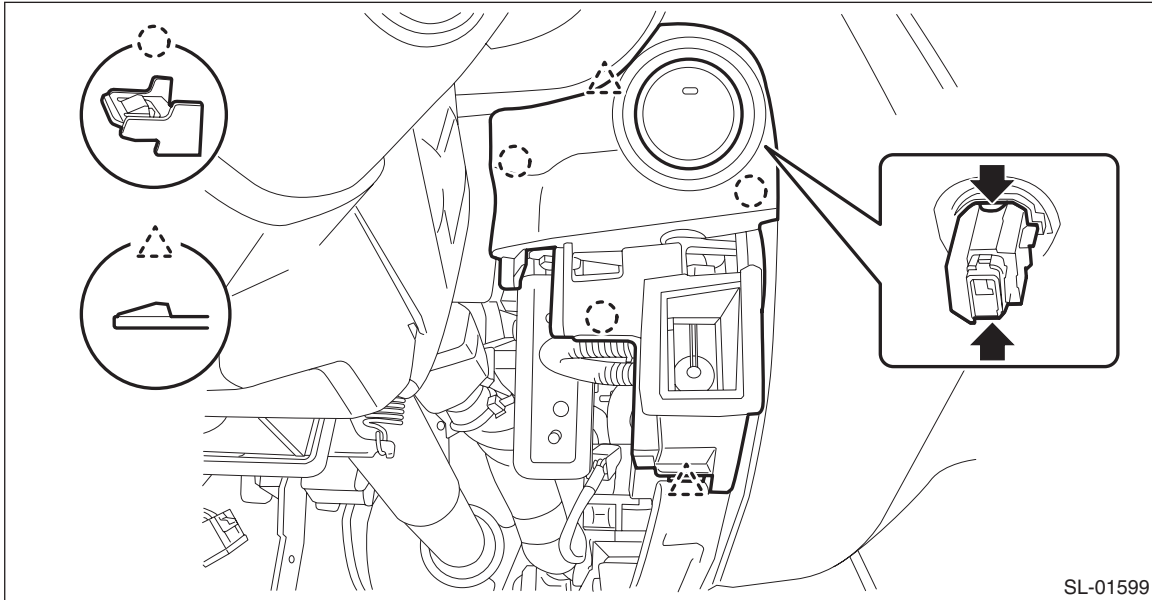

- 7) Remove the knee airbag module. <Ref. to AB-35, REMOVAL, Knee Airbag Module.>

- 8) Release the clips and claws, then detach the left and right grille speaker side.

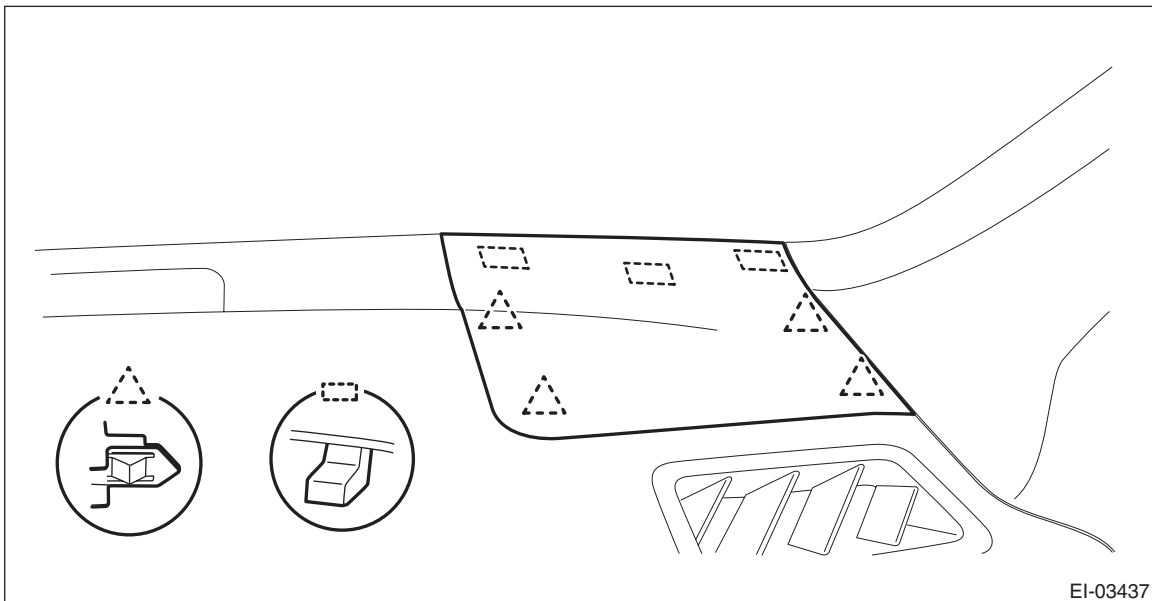

**NOTE:**

Remove the grille speaker side by using a plastic remover.

- 9) Remove the trim panel - front pillar UPR on the left and right sides. <Ref. to EI-85, REMOVAL, Upper Inner Trim.>

- 10) Remove the glove box assembly. <Ref. to EI-63, REMOVAL, Glove Box.>

- 11) Remove the panel center assembly. <Ref. to EI-66, REMOVAL, Center Console.>

- 12) Remove the audio assembly or navigation assembly. <Ref. to ET-8, REMOVAL, Audio.>

- 13) Remove the multi-function display assembly. <Ref. to IDI-20, REMOVAL, Multi-function Display (MFD).>

- 14) Remove the combination meter assembly. <Ref. to IDI-13, REMOVAL, Combination Meter.>

## Passenger's Airbag Module

### AIRBAG SYSTEM

15) Disconnect the passenger's airbag module connector. <Ref. to AB-19, PASSENGER'S AIRBAG MODULE, PROCEDURE, Airbag Connector.>

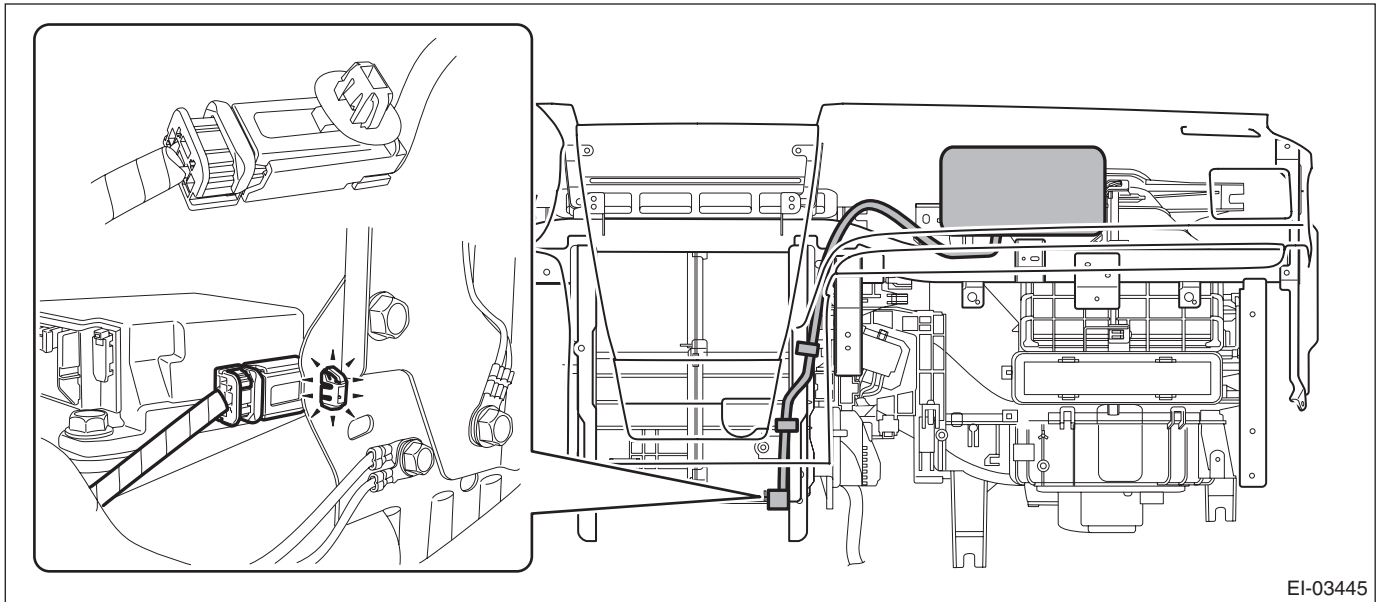

16) Remove the column assembly - steering. <Ref. to PS-25, REMOVAL, Steering Column.>

17) Remove the cover side sill - front INN and cover side sill - front on the RH and LH side. <Ref. to EI-81, REMOVAL, Lower Inner Trim.>

18) Remove the body side weather strip - flange front.

19) Remove the instrument panel assembly and the beam COMPL - steering as a unit. <Ref. to EI-69, REMOVAL, Instrument Panel Assembly.>

20) Remove the screws and remove the front (A) and side vent duct (B) LH, RH.

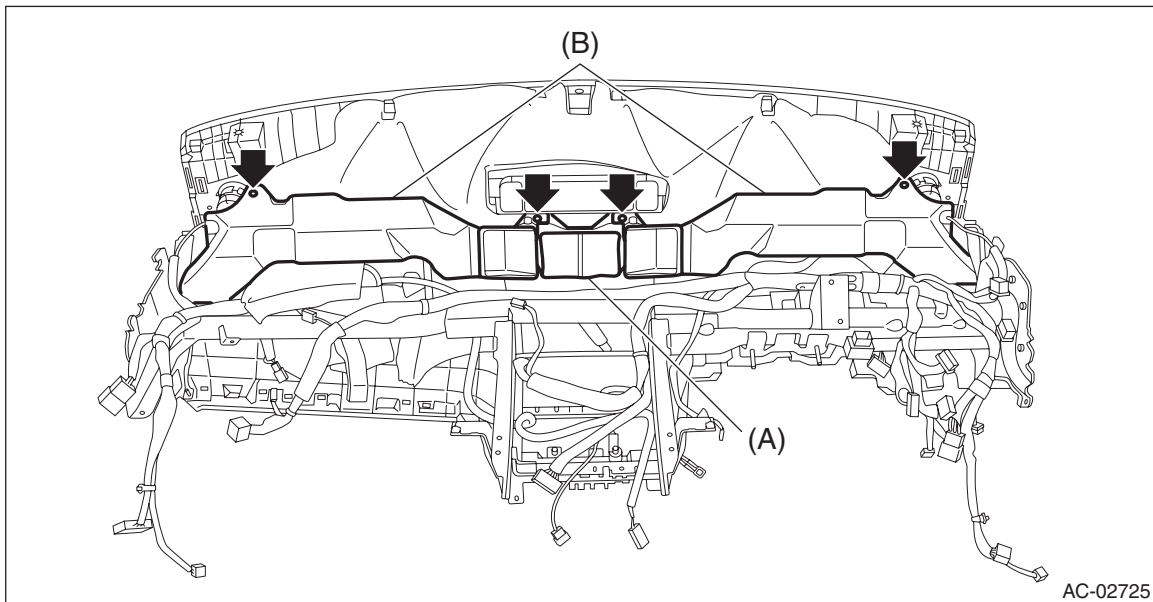

- 21) Separate the panel COMPL - instrument and the beam COMPL - steering.  
(1) Remove the clamps and bolts of the passenger's airbag module harness.

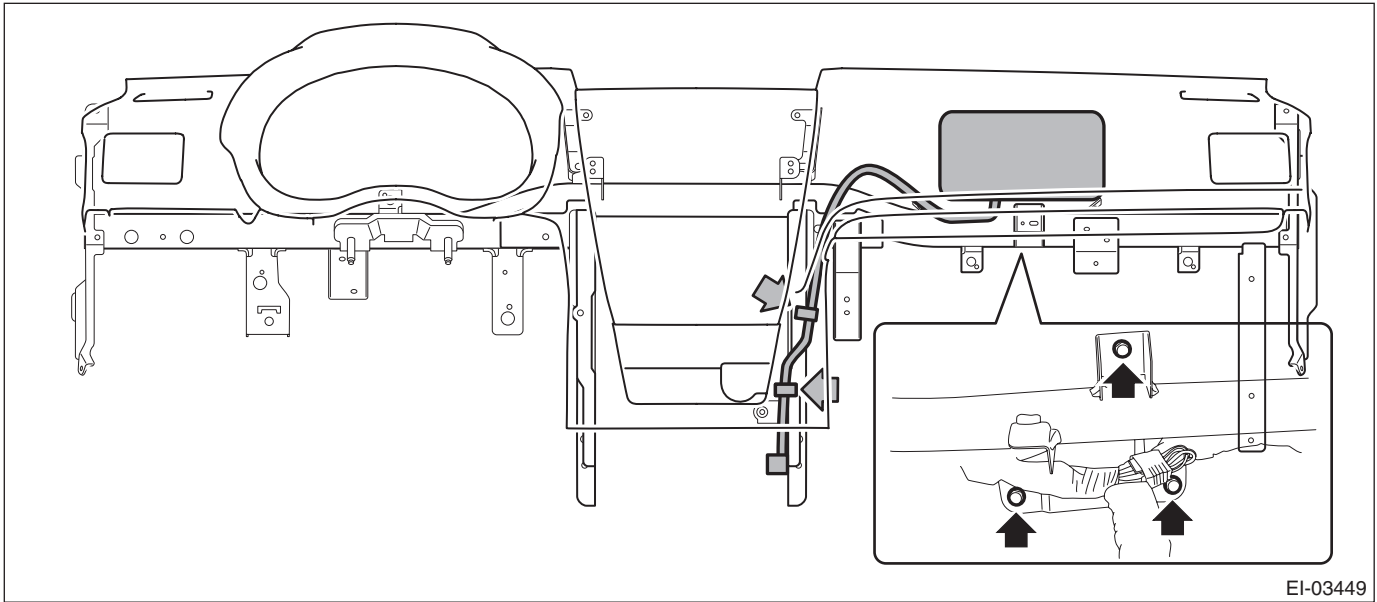

- (2) Disconnect the connectors of the left and right speakers and the sensor - sunload.

**NOTE:**

Detach the harness clamp together.

- (3) Disconnect the front accessory socket connector.  
(4) Remove the nut (a) and screws (b), (c), (d), (e), (f), (g) and (h).

## Passenger's Airbag Module

### AIRBAG SYSTEM

(5) While being careful with the harness, separate the panel COMPL - instrument and the beam COMPL - steering.

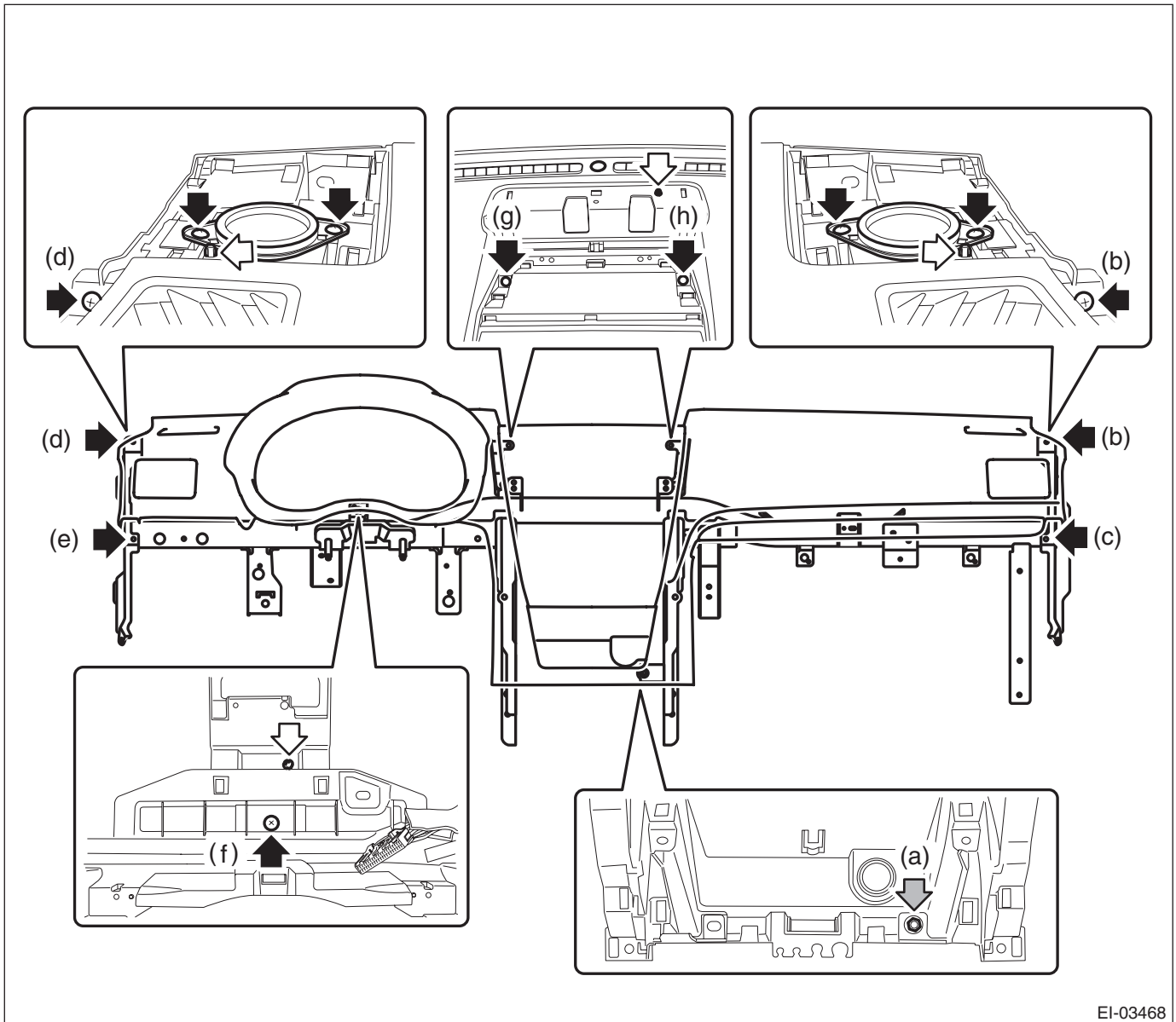

22) Remove the claws, and remove the passenger's airbag module.

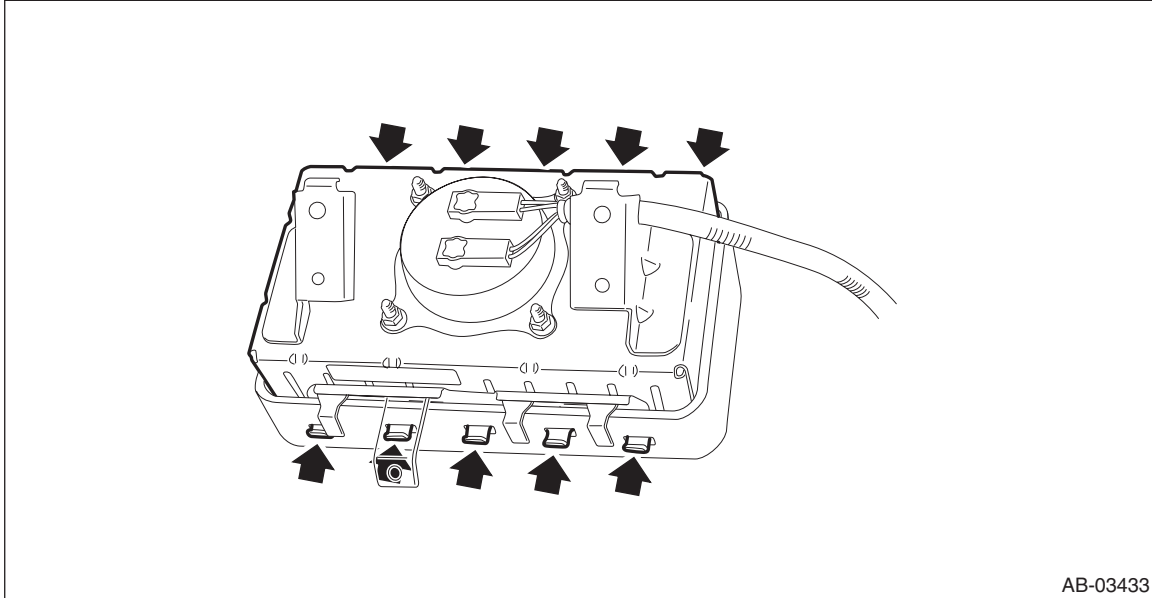

23) For handling of the removed airbag module, refer to "CAUTION". <Ref. to AB-9, CAUTION, General Description.>

### B: INSTALLATION

#### CAUTION:

- Refer to “CAUTION” of “General Description” before handling the airbag module. <Ref. to AB-9, CAUTION, General Description.>
- Do not allow harness and connectors to interfere or get tangled up with other parts.
- When reusing the tether clip on the upper part of the trim panel - front pillar UPR, check that there is no damage to the tether clip. If the clip is damaged, its holding force is reduced and the trim panel - front pillar UPR may come off. Be sure to replace it with a new clip.

1) Before installation, inspect the following items and replace any faulty part with a new one.

- Passenger's airbag lid (instrument panel surface) is cracked or deformed.
- Airbag module is cracked or deformed.
- Harness and/or connector is cracked, deformed or open.
- Harness wire is exposed.
- Mounting bracket is cracked or deformed.

2) Install the instrument panel assembly. <Ref. to EI-77, INSTALLATION, Instrument Panel Assembly.>

3) Install the cover side sill - front on the RH and LH sides.

4) Install the cover side sill - front INN on the RH and LH sides.

5) Install the column assembly - steering. <Ref. to PS-28, INSTALLATION, Steering Column.>

6) Install the combination meter assembly.

7) Install the multi-function display assembly.

8) Install the audio assembly or navigation assembly.

9) Install the panel center assembly.

10) Install the globe box assembly.

11) Install the trim panel - front pillar UPR on the RH and LH sides. <Ref. to EI-87, INSTALLATION, Upper Inner Trim.>

12) Install the grille speaker side on the RH and LH sides.

13) Install the knee airbag module.

#### **Tightening torque:**

**7.5 N·m (0.8 kgf-m, 5.5 ft-lb)**

14) Install the panel - switch. (Only model with keyless access)

15) Install the cover switch - starter. (Only model without keyless access)

16) Install the cover assembly - instrument panel LWR driver.

17) Install the panel center LWR on the RH and LH sides.

18) Install the cover - shift lever and the console box assembly.

19) Connect the battery ground terminal. <Ref. to NT-5, BATTERY, NOTE, Note.>

#### NOTE:

For models other than STI model, connect the ground terminal to battery sensor.